

HIGH ROLLER

ADULT SIZE. RACE READY.

High Roller Mark 2 Adult Size big wheel trike

Assembly Manual



1.0 **TOOLS INCLUDED:**

19mm cone wrench for wheels
 4mm & 5mm allen wrench for stem
 6mm allen wrench for frame bolts
 13mm wrench for seat bracket and frame bolts
 14mm wrench for headset adjustment
 15mm wrench for pedals
 10mm box wrench for Fork clamps

2.0 **QUICK ASSEMBLY (FOR THOSE WITH ADD)**

1. Bolt Frame together
2. Install Rear Wheels
3. Install Front Wheel and Handlebars
4. Install Seat
5. Install Pedals
6. Read the rest of these Instructions!
7. Go Ride!

page 1 of 6

HIGH ROLLER

ADULT SIZE. RACE READY.

3.0 DETAILED ASSEMBLY

1. On a padded surface (like the box the High Roller came in) to protect the paint, bolt together the Main Frame and Rear Frame with the Bolts, Washers and Nuts.

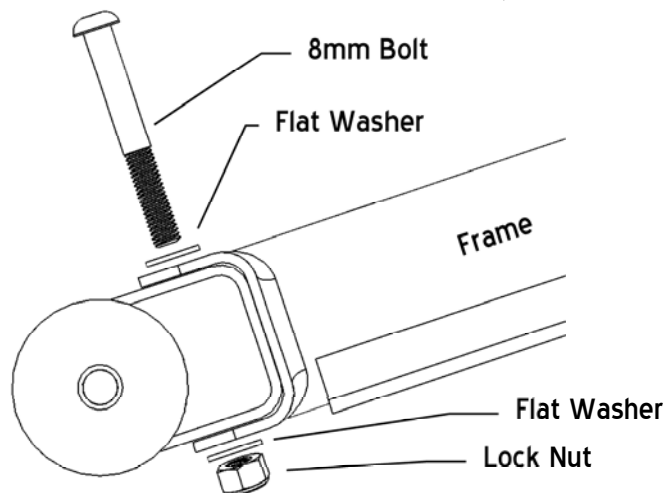

2. To install the Rear Wheels:
 - a. Install the Axle Bolt into the Frame, real tight.
 - b. Assemble the Washer, Rear Wheel, Washer, and Nut onto the Axle Bolt.
 - c. Tighten the nut. Here, real tight is real good. ⚠️ Check & tighten nuts during first 20 miles of riding.

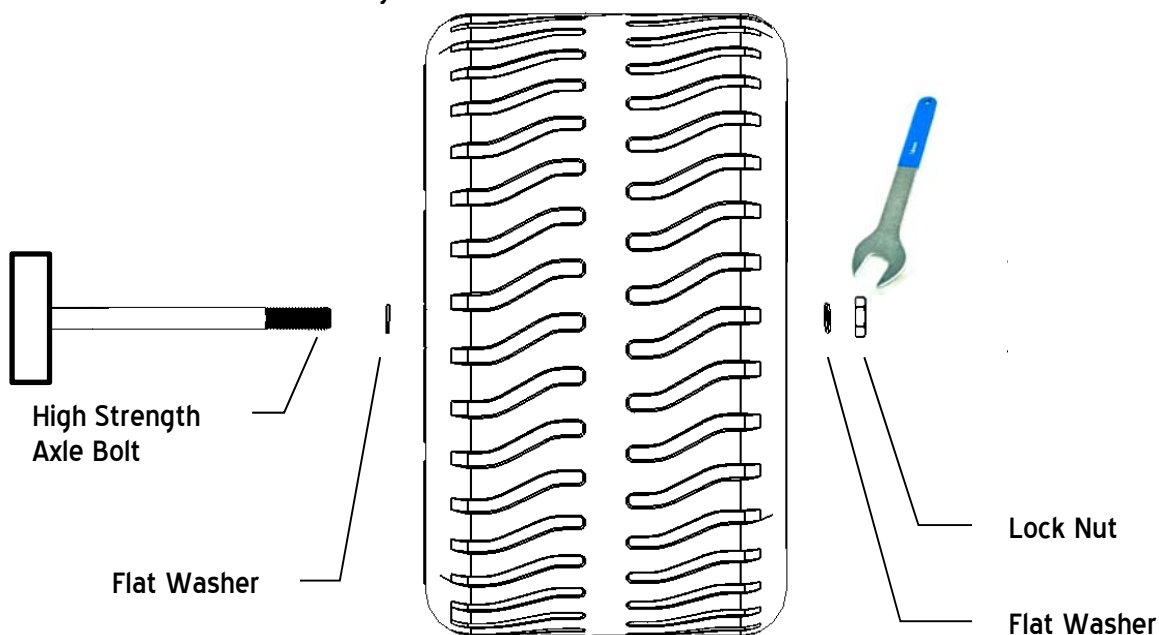

HIGH ROLLER

ADULT SIZE. RACE READY.

3. To install the Front Wheel.

- a. First unclip the Brake Cable from the Keeper on the brake arm to open the brakes.

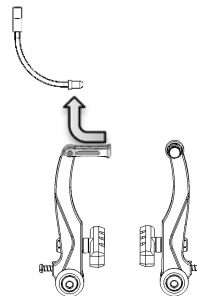

- b. Flip the High Roller on its back with the Forks pointing up and drop the Front Wheel into the fork.

 Make sure that the RIGHT crank arm is on the RIGHT side. You can match up the "R" on the crank arm with the big "R" in the "HIGH ROLLER" decal.



- c. Install the Fork Clamps with Bolt, Washer, and Nut with the 10mm wrench.

Note that the Bolt head is "keyed" and fits into the notch in the fork clamp.

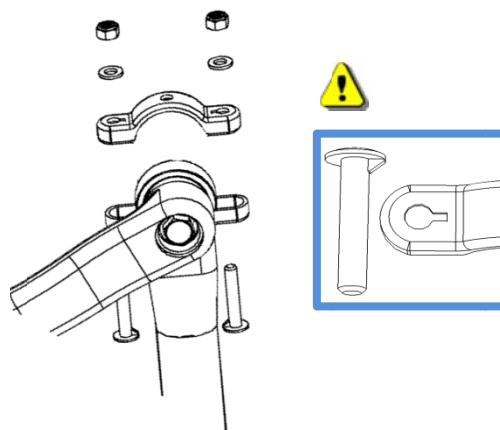

HIGH ROLLER.

ADULT SIZE. RACE READY.

- d. Tighten the nut until it is flush with the end of the bolt.

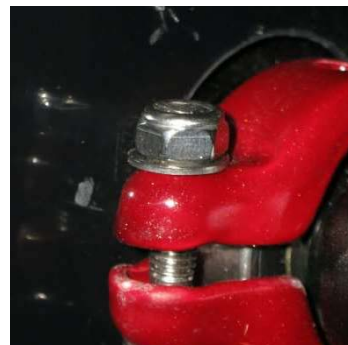

- e. Put the Brake Cable back into the Keeper.

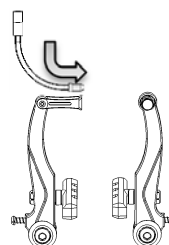

4. Flip the High Roller back over and install the Handlebars.
- The angle should be half way between straight up, and in-line with the fork.
 - Go around several times and slowly tighten the Stem bolts evenly on the handlebars.

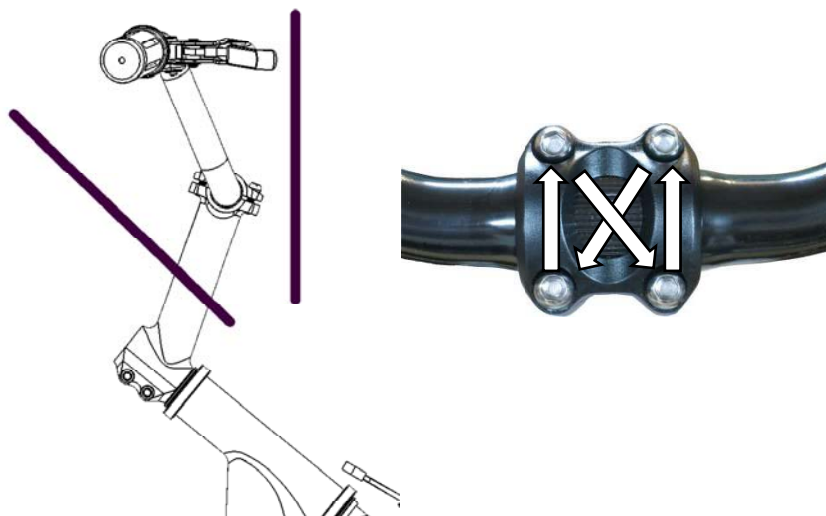

HIGH ROLLER

ADULT SIZE. RACE READY.

5. Install the Seat by:
 - a. Mounting the Seat Bracket to the bottom of the Seat with the Bolts and Washers.

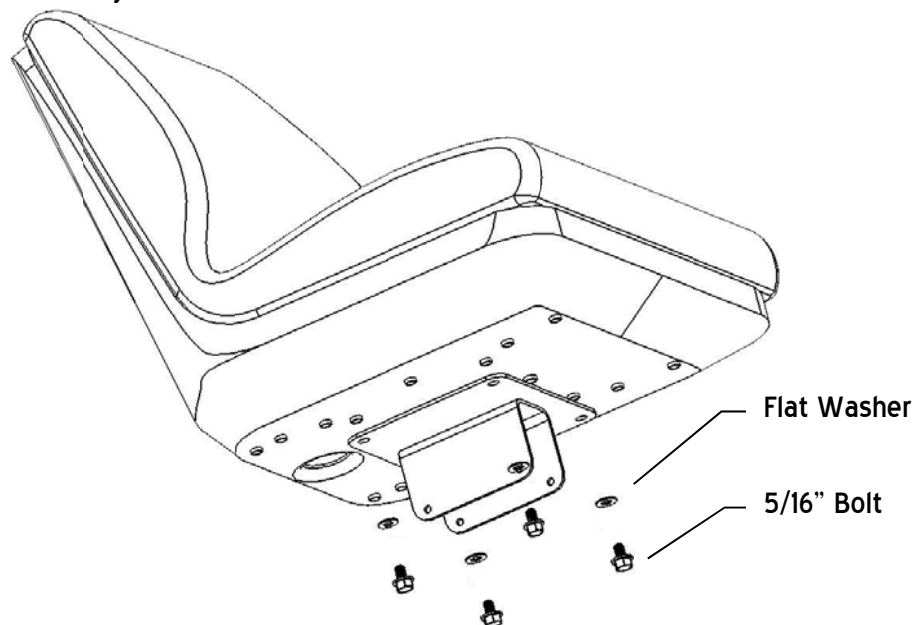

- b. Slide the Seat onto the Frame and install the Quick Release Levers.

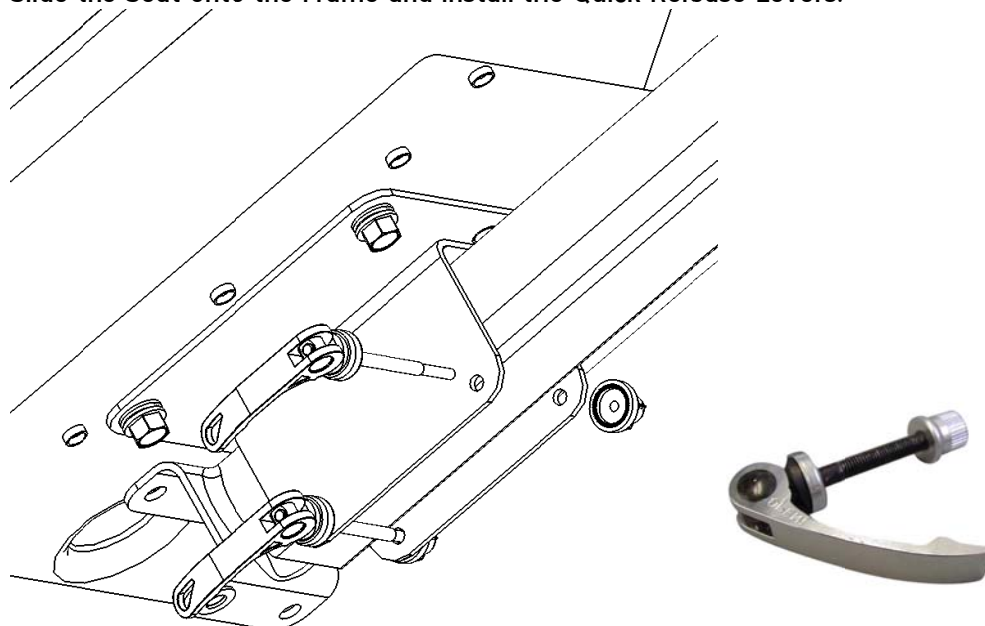



- c. The Levers are NOT wing nuts, they are cams. With the Lever pointed straight out from the frame, tighten by hand then fold the lever over and check for tightness. Adjust as necessary. Go a little tighter than you think you should.

HIGH ROLLER

ADULT SIZE. RACE READY.

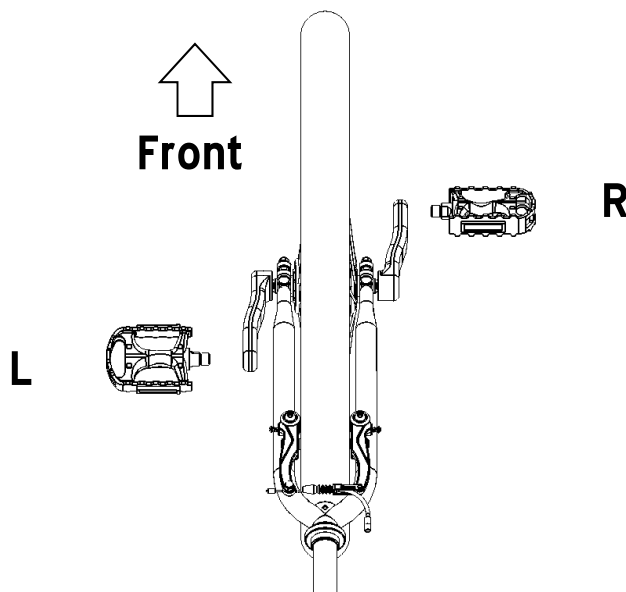
6. Install the RIGHT hand and LEFT hand pedals with the supplied wrench. Arrows on the pedals will tell you which way to turn (spin forward).



7. Go Ride!
8. Tips:
-  Check & tighten REAR AXLE bolts and nuts during first 20 miles of riding.
 - ALWAYS wear a helmet (your head is at bumper level).
 - LEAN INTO the turns!
 - Check the REAR AXLE bolts regularly and tighten if necessary.
 - No brake for the best Power Slides.
 - Check your local regulations to see if your High Roller is street legal or just for paths.

Should you need any assistance, please feel free to contact us at:

High Roller USA
Sales@HighRollerUSA.com
<https://www.HighRollerUSA.com>
720-989-1969